

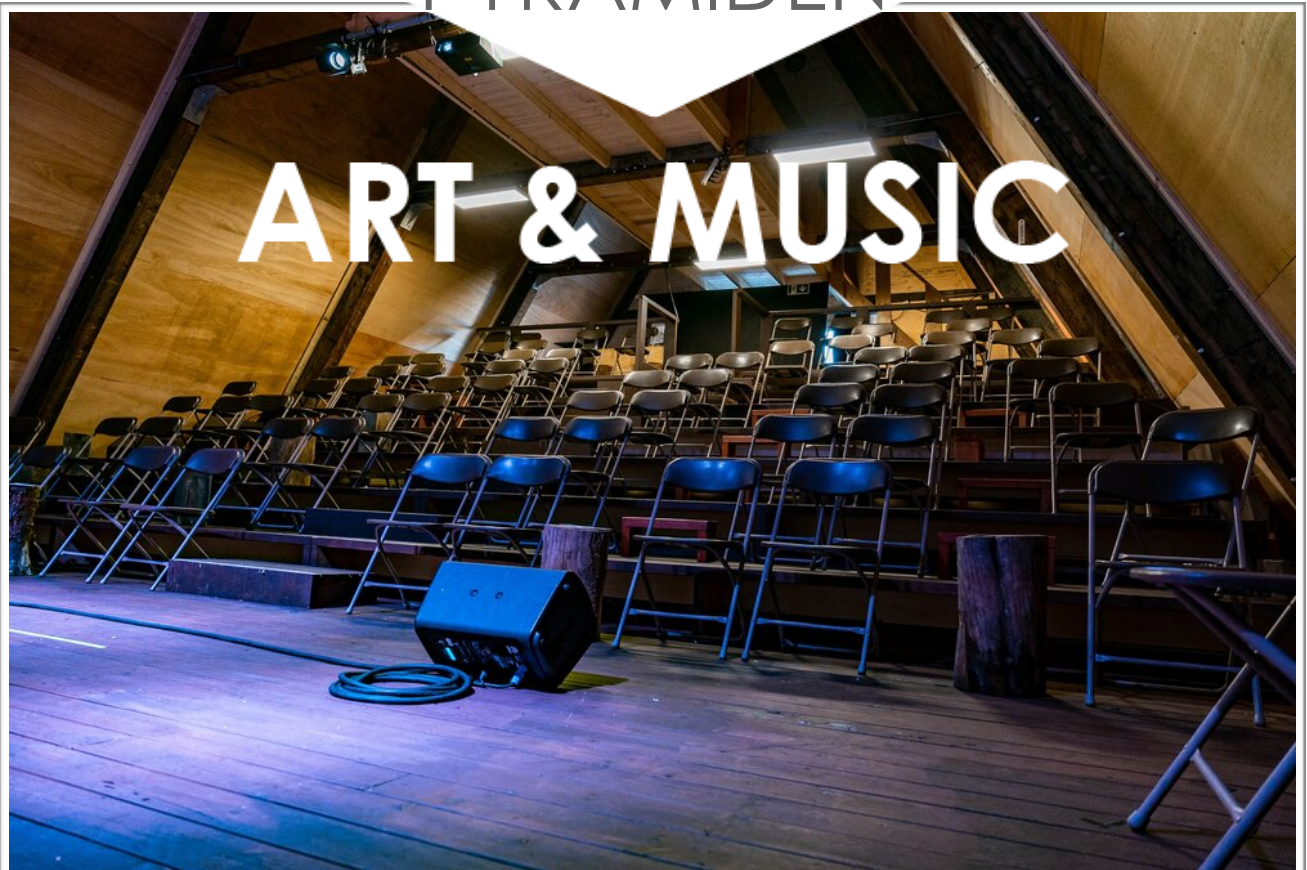

# SALT

PYRAMIDEN







## PYRAMIDEN

FOH		PA	
Audio	Midas M32R + DL32	Top	Turbosound iQ15B x 2
Light	ETC Colorsource 20	Sub	Turbosound iQ12 x 2
Video	Panasonic Bluray Atlona HDMI scaler Optoma ZU606ST (HDMI on stage and FOH) Screen: 6x4m	Monitor	QSC K10/K10.2 x 8
STAGE			
Size	5x3m		
Seating	Amphitheater		
Capacity	100 pax		
Notes	Emergency exit stage right Main entrance and outdoor seating on top of amphitheatre		
Backstage	Second floor		
Fixture	Mode	ID	DMX
Bright xBaby	3 ch		1 1-3
Bright xBaby	3 ch		2 4-6
Bright xBaby	3 ch		3 7-9
Bright xBaby	3 ch		4 10-12
Bright xLED	5 ch		5 20-24
Bright xLED	5 ch		6 30-34
Bright xLED	5 ch		7 40-44
Bright xLED	5 ch		8 50-54
Bright xLED	5 ch		9 150-154
Bright xLED	5 ch		10 160-164
Prolights Eclipse FS	8 ch		11 200-207
Prolights Eclipse FS	8 ch		12 208-215
MICROPHONES			
SM58		4 DI	3 x mono 1 x stereo
SM57		3	
B52		1	
B91		1	
E604		3	
E614		1 Backline	Upright piano

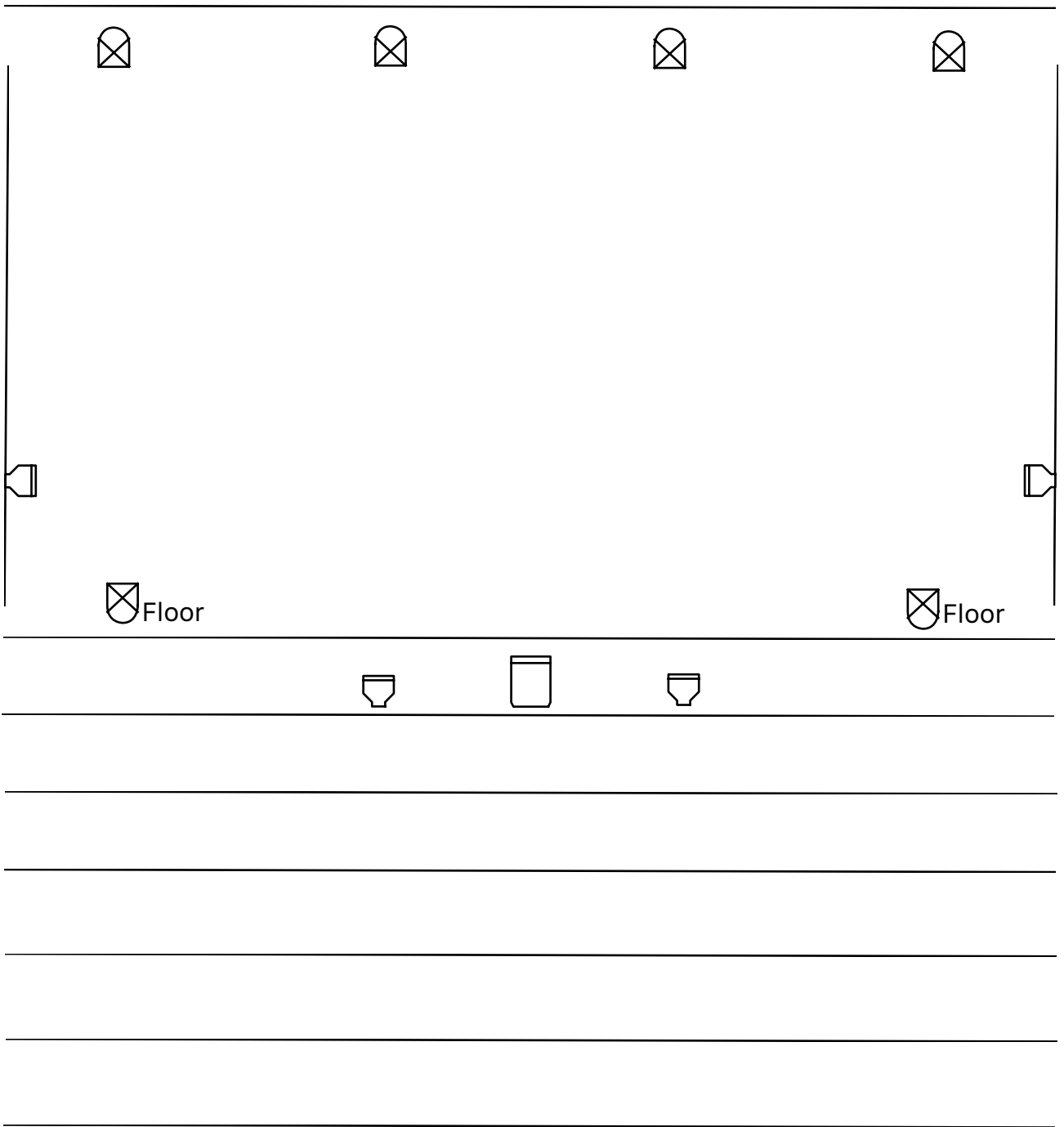
5m

3m

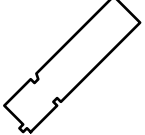
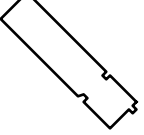

	Bright xBaby 3 ch		Optoma ZU606 ST
	Bright xLED 5 ch		
	Prolights Eclipse FS 8 ch		

**FOH**